



Check Parts

The System should be partially assembled when you open the box.

For missing parts or support please contact AquaReady support at:

getaquaready.com/support/

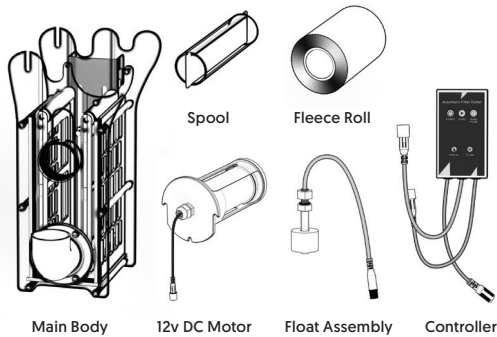

Mounting

The AquaReady Automatic Filter Roller can be mounted inside of a sump using the hanging bracket on the back of the main body.

Connect to drain line of aquarium.

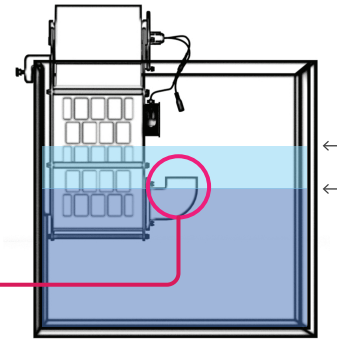

Power and Controller

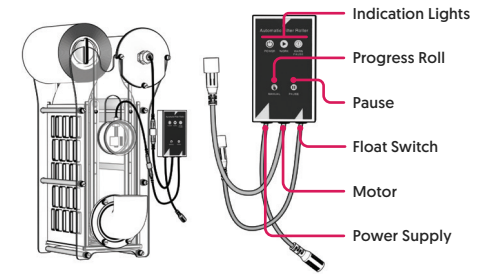

Assembly

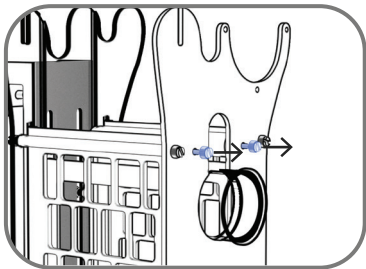

1. Remove the screws holding in the roller assembly as shown in the illustration.

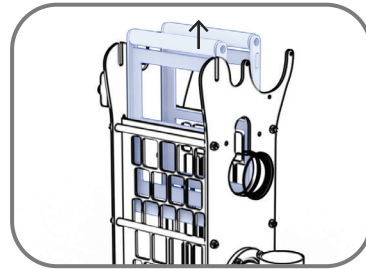

2. Lift both sides of the pulley system out of the main body assembly.

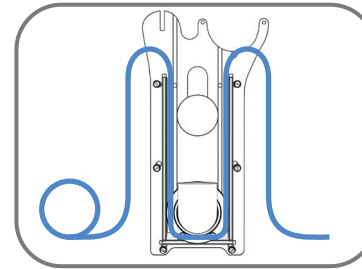

3. Place the fleece roll onto the spool, and pull out some filter fleece (about 36") then insert fleece into the bottom of the main body chamber.

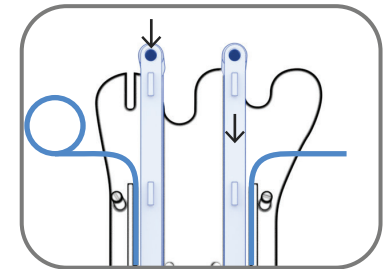

4. Place pulley system back into the main body chamber then re-screw to secure.

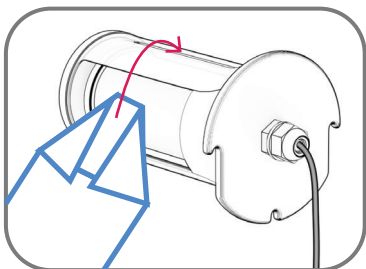

5. Fold the end of the fleece into a triangle, and place it into the motor. Spin the motor to help it catch and make sure it won't come loose.

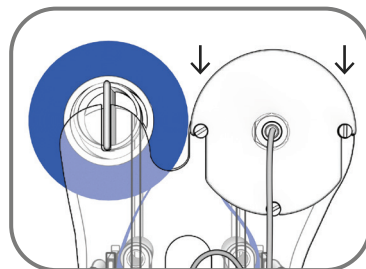

6. Place the motor with fleece onto the back bracket of the main body.

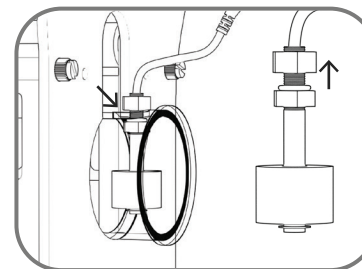

7. Loosen the hex nut on the float switch and put it into the space on the front of the body wall, tighten in place. Next connect the controller wire.

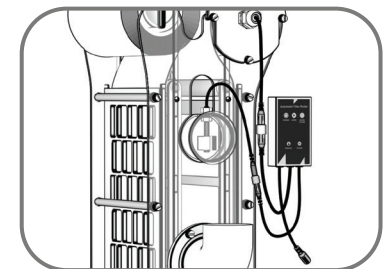

8. Connect the controller advance the roll by pressing the manual button for about 2-3 turns of the filter paper, while doing this check for smooth operation.



Replacing the Filter Fleece

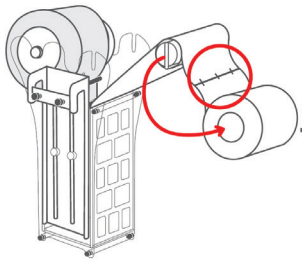

1. Pick up the old fleece roll, staple the end side with a new fleece roll, then place the new spool onto the filter.

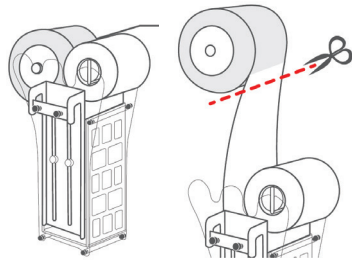

2. Press the red button to make the new fleece roll onto the motor, once it is attached to the motor, cut it off.

3. Pick up the motor and loosen the screw on the cover, and separate the cover with the used fleece from the motor.

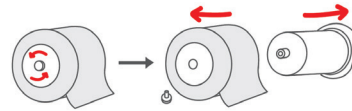

4. Use the paper roll of the old fleece to collect the old fleece, and you can get the cover of the motor.

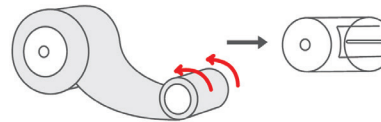

5. Install the cover onto the motor, and tighten back down with the screw.

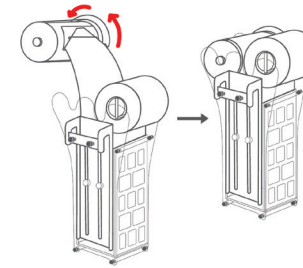
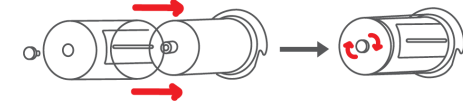

6. Fold the end of fleece into a triangle and place into the slot on the motor. Spin the motor to help it catch, then install the motor and press the red button to tighten the roll down.

If the old fleece has completely run out, use the following steps:

(Refer back to steps 1-6 of initial setup instructions)

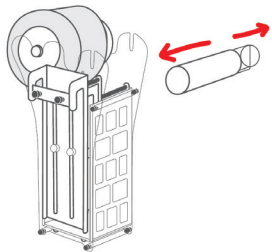

1. Take the used paper roll off of the plastic spool.

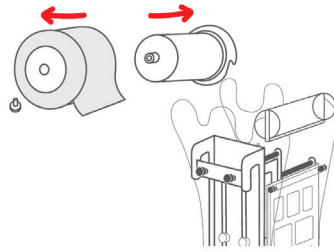

2. Pick up the motor and loosen the screw on the cover of the motor and separate the dirty fleece roll.

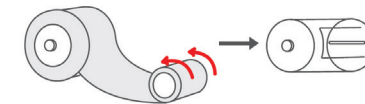

3. Use the paper roll of the old fleece roll to collect the old fleece to free up the cover of the motor.

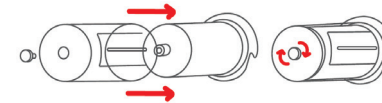

4. Install the cover onto the motor and tighten screw.

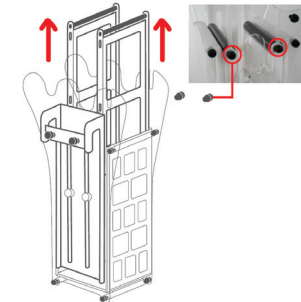

5. Remove the screws marked on the image then pull out the pulley system.

6. Take a new roll and pull out about 36" of length. Put the fleece into the chamber then put back the pulley system and screws.

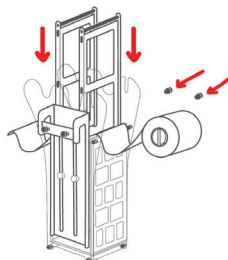

7. Fold the end of the fleece into a triangle, place it into the motor and spin the motor to help it catch. Next install the motor and press the red button to make sure that it is firmly attached.

